

## NATURE RESERVE - Gauteng

Gazetted Name: Melville Koppies Private Nature Reserve

Action as Gazetted	Gazette	Notice no. & year	Page No.	Extent (morgen/ha)
Change to Private Nature Reserve	2751	No. 14 11 February 1959	1, 3-4	48,95 morgen
Declaration of Reserve	3256	No. 62 15 February 1967	13	30 morgen

DIE PROVINSIE TRANSVAAL  
**Buitengewone**  
**Offisiële Koerant.**

(As 'n Nuusblad by die Poskantoor Geregistreer)



THE PROVINCE OF TRANSVAAL  
**Official Gazette**  
**Extraordinary.**

(Registered at the Post Office as a Newspaper)

VOL CLXVIII.]    PRYS 6d.    PRETORIA, 11 FEBRUARIE 1959.    PRICE 6d.    [No. 2751.

No. 14 (Administrateurs-), 1959.]

### PROKLAMASIE

DEUR SY EDELE DIE ADMINISTRATEUR VAN DIE  
PROVINSIE TRANSVAAL.

Nademaal daar by paragraaf (d) van artikel *elf* van die Wildordonnansie, 1949 (Ordonnansie No. 23 van 1949), soos gewysig, bepaal word dat die Administrateur van tyd tot tyd, na verwysing na die Raad van Advies insake Fauna en Flora, by Proklamasie in die *Staatskoerant* 'n omskrewre gebied tot 'n wildreserwe kan verklaar;

En nademaal daar by paragraaf (a) van subartikel (2) van artikel *twee* van die Ordonnansie op die Beskerming van Inheemse Flora, 1940 (Ordonnansie No. 9 van 1940), soos gewysig, bepaal word dat die Administrateur van tyd tot tyd, by Proklamasie in die *Offisiële Koerant van die Provinsie Transvaal* een of meer reserwes vir inheemse flora kan instel;

So is dit dat ek, kragtens en ingevolge voornoemde bevoegdhede, en na verwysing na genoemde Raad, hierby verklaar dat die gebiede in die Bylae by hierdie Proklamasie omskryf, voortaan wildreserwes en reserwes vir inheemse flora is waarop die bepalinge van genoemde Ordonnansies van toepassing is, en dat genoemde reserwes bekend sal staan onder die onderskeie name soos in genoemde Bylae uiteengesit.

GOD BEHOEDE DIE KONINGIN.

Gegee onder my Hand te Pretoria, op hede die Twee-en-twintigste dag van Desember Eenduisend Negehonderd Agt-en-vyftig.

F. H. ODENDAAL,  
Administrateur van die Provinsie Transvaal.  
F.F. 42.

No. 14 (Administrator's), 1959.]

### PROCLAMATION

BY THE HONOURABLE THE ADMINISTRATOR OF THE  
PROVINCE OF TRANSVAAL.

Whereas it is provided in paragraph (d) of section *eleven* of the Game Ordinance, 1949 (Ordinance No. 23 of 1949), as amended, that the Administrator may, from time to time, after reference to the Fauna and Flora Advisory Board, by Proclamation in the *Gazette*, declare any defined area to be a game reserve;

And whereas it is provided in paragraph (a) of subsection (2) of section *two* of the Native Flora Protection Ordinance, 1940 (Ordinance No. 9 of 1940), as amended, that the Administrator may from time to time, by Proclamation in the *Provincial Gazette of the Province of Transvaal* establish one or more native flora reserves;

Now, therefore, under and by virtue of the aforesaid powers, and after reference to the said Board, I do hereby declare that the areas defined in the Schedule to this Proclamation shall henceforth be game reserves and native flora reserves, to which the provisions of the said Ordinances shall apply, and that the said reserves shall be known by the respective names set out in the said Schedule.

GOD SAVE THE QUEEN.

Given under my Hand at Pretoria on this Twenty-second day of December, One thousand Nine hundred and Fifty-eight.

F. H. ODENDAAL,  
Administrator of the Province of Transvaal.  
F.F. 42.

MELVILLE KOPPIES-NATUURRESERVAAT, DISTRIK  
JOHANNESBURG.

(Grootte: 48.95 morg.)

Beginnende by die punt waar die suidelike grens van Judithweg en Orangeweg die westelike grens van die dorp Emmarentia kruis; en vandaar ongeveer 1,500 Kaapse voet ver in 'n suidelike rigting al met die westelike grens van genoemde voorstad langs tot by 'n baken; vandaar ongeveer 780 Kaapse voet ver in 'n suidwestelike rigting al met die grense van die dorpe Emmarentia, en Melville langs; vandaar ongeveer 660 Kaapse voet ver in 'n noordwestelike rigting al met die grens van die voorstad Melville langs, en dan ongeveer 1,080 Kaapse voet ver in 'n suidwestelike rigting al met die noordelike grens van die dorp Melville langs tot by die noordoostelike baken van genoemde dorp; vandaar ongeveer 470 Kaapse voet ver in 'n noordwestelike rigting, oor die spruit, tot by 'n baken op die westelike hoek van Gedeelte G van gedeelte van die plaas Braamfontein No. 11; vandaar ongeveer 1,075 Kaapse voet ver in 'n noord-noordwestelike rigting oor Gedeelte E van gedeelte van die plaas Braamfontein No. 11 tot by 'n punt op die suidelike grens van die gebied wat as die Wesparkse Begraafplaas bekend is; vandaar ongeveer 700 Kaapse voet ver in 'n noordoostelike

MELVILLE KOPPIES NATURE RESERVE, DISTRICT OF  
JOHANNESBURG.

(Extent: 48.95 morgen.)

Commencing at the intersection of the south boundary of Judith Road and Orange Road with the western boundary of Emmarentia Township; and proceeding in a southerly direction along the western boundary of the said township for a distance of approximately 1,500 Cape feet to a beacon; thence in a south-westerly direction along the boundaries of Emmarentia and Melville Townships for a distance of approximately 780 Cape feet; and continuing in a north-westerly direction along the boundary of Melville Township for a distance of approximately 660 Cape feet and then in a south-westerly direction for 1,080 Cape feet along the northern boundary of Melville Township to the north-eastern beacon of the said township; thence in a north-westerly direction for a distance of approximately 470 Cape feet and across the stream to a beacon on the western corner of Portion G of portion of farm Braamfontein No. 11; thence in a north-north-westerly direction across Portion E of portion of the farm Braamfontein No. 11 for a distance of approximately 1,075 Cape feet to a point on the south boundary of the area known as West Park Cemetery; thence in a north-easterly direction along the side of the

begraafplaas tot by 'n punt waar genoemde heining by die westelike grens van Muldersdriftweg aansluit; vandaar 440 Kaapse voet ver in 'n suidelike rigting; vandaar ongeveer 460 Kaapse voet ver in 'n oostelike rigting oor genoemde Muldersdriftweg tot by 'n baken op die suidelike grens van Judithweg, en dan verder in 'n oostelike rigting, ongeveer 2,150 Kaapse voet ver al met hierdie grens langs tot by die aanvangspunt. Muldersdriftweg wat oor hierdie eiendom loop, is nie by hierdie beskrywing ingesluit nie.

approximately 700 Cape feet to a point where the said fencing meets the western boundary of the Muldersdrift Road; thence in a southerly direction for a distance of 4 Cape feet; thence in an easterly direction across the said Muldersdrift Road for a distance of approximately 4 Cape feet to a beacon on the southern boundary of Judith Road, and continuing in an easterly direction along the boundary for a distance of approximately 2,150 Cape feet and terminating at the point where this description commenced. The Muldersdrift Road which passes through this property is not included in this description.

MELVILLE KOPPIES-NATUURRESERVAAT.  
MELVILLE KOPPIES NATURE RESERVE.

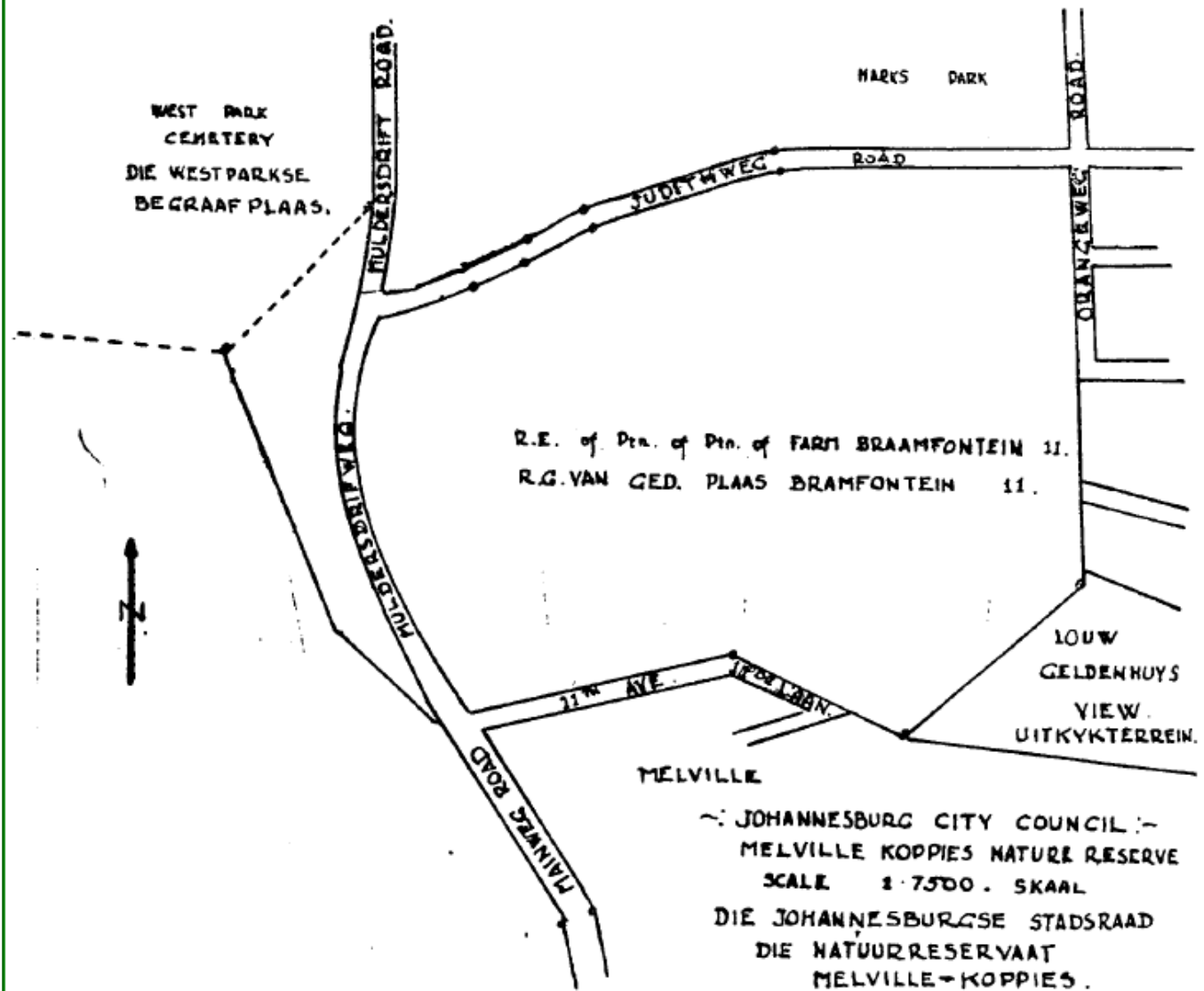

DIE PROVINSIE TRANSVAAL  
Guitengewone  
Offisiële Koerant.

(As 'n Nuusblad by die Poskantoor Geregistreer)



THE PROVINCE OF TRANSVAAL  
Official Gazette  
Extraordinary.

(Registered at the Post Office as a Newspaper)

VOL. 200.]

PRYS 5c.

PRETORIA, 15 FEBRUARIE 1967.  
15 FEBRUARY

PRICE 5c.

[No. 3256.

No. 62 (Administrateurs-), 1967.]

### PROKLAMASIE

DEUR SY EDELE DIE ADMINISTRATEUR VAN DIE  
PROVINSIE TRANSVAAL.

Nademaal daar by artikel 11 (d) van die Wild-ordonnansie, 1949 (Ordonnansie No. 23 van 1949), bepaal word dat die Administrateur van tyd tot tyd, na verwysing na die Raad van Advies insake Fauna en Flora, by proklamasie in die *Staatskoerant* enige gebied in sodanige proklamasie omskryf 'n wildreserwe kan verklaar tot tyd en wyl dit gedeproklameer word;

En nademaal daar by artikel 2 (2) van die Ordonnansie op die Beskerming van Inheemse Flora, 1940 (Ordonnansie No. 9 van 1940), bepaal word dat die Administrateur van tyd tot tyd by proklamasie in die *Offisiële Koerant van die Provinsie Transvaal* een of meer reserwes vir inheemse flora kan instel of so 'n reserwe kan ophef, met ingang van 'n bepaalde datum;

So is dit dat ek, kragtens en ingevolge voornoemde bevoegdhede, en na verwysing na die genoemde Raad, hierby verklaar dat elk van die gebiede in die Bylae hierby omskryf, met ingang van 13 Desember 1966, beide 'n wildreserwe en 'n reserwe vir inheemse flora is waarop die bepalinge van genoemde Ordonnansies van toepassing sal wees;

En vir algemene inligting word hierby bekendgemaak dat ek die naam wat in voormelde Bylae hierby aangedui word, aan elk van die reserwes toegeken het.

Gegee onder my Hand te Pretoria, op hede die Dertiende dag van Desember Eenduisend Negenhonderd Ses-en-sestig.

S. G. J. VAN NIEKERK,

No. 62 (Administrator's), 1967.]

### PROCLAMATION

BY THE HONOURABLE THE ADMINISTRATOR OF THE  
PROVINCE OF TRANSVAAL.

Whereas it is provided in section 11 (d) of the Game Ordinance, 1949 (Ordinance No. 23 of 1949), that the Administrator may, from time to time, after reference to the Fauna and Flora Advisory Board, by proclamation in the *Gazette*, declare any area defined in such proclamation to be a game reserve until it is deproclaimed;

And whereas it is provided in section 2 (2) of the Native Flora Protection Ordinance, 1940 (Ordinance No. 9 of 1940), that the Administrator may from time to time by proclamation in the *Provincial Gazette of the Province of Transvaal*, establish one or more native flora reserves or cancel any such reserve, with effect from a stipulated date;

Now, therefore, under and by virtue of the aforesaid powers, after reference to the said Board, I do hereby declare that each of the areas defined in the Schedule hereto shall from the 13th December, 1966, be both a game reserve and a native flora reserve to which the provisions of the said Ordinances will apply;

And for general information it is hereby made known that I have assigned to each reserve the name indicated in the said Schedule hereto.

Given under my Hand at Pretoria on this Thirteenth day of December. One thousand Nine hundred and Sixty-six.

S. G. J. VAN NIEKERK.

#### MELVILLE KOPPIES-PRIVAATNATUURRESERVAAT, DISTRIK JOHANNESBURG.

(Grootte: 30 morg.)

Beginnende by die suidwestelike baken van Gedeelte E van die gedeelte van die plaas Braamfontein No. 53—I.R.; vandaar in 'n noordelike en noordwestelike rigting langs

#### MELVILLE KOPPIES PRIVATE NATURE RESERVE, DIST OF JOHANNESBURG.

(Extent: 30 morgen.)

Commencing at the south-western beacon of Portic of the portion of the farm Braamfontein No. 53—thence in a northerly and north-westerly direction a

die westelike grens en met inbegrip van Gedeelte E van die gedeelte van die plaas Braamfontein No. 53—I.R. tot by die noordwestelike baken daarvan; vandaar in 'n suid-oostelike rigting langs die noordelike grens en met inbegrip van Gedeelte E van die gedeelte van die plaas Braamfontein No. 53—I.R. tot by die noordoostelike baken daarvan; vandaar in 'n algemene suidoostelike rigting langs die oostelike grens en met inbegrip van Gedeelte E van die gedeelte en Gedeelte G van die gedeelte van die plaas Braamfontein No. 53—I.R. tot by die suidoostelike baken van laasgenoemde gedeelte; vandaar in 'n algemene suidwestelike en algemene noordwestelike rigting, langs die suidelike grense en met inbegrip van Gedeelte G van die gedeelte en Gedeelte E van die gedeelte van die plaas Braamfontein tot by die suidwestelike baken van laasgenoemde gedeelte, die aanvangspunt.

the western boundary of and including Portion E of the portion of the farm Braamfontein No. 53—I.R. to the north-western beacon thereof; thence in a south-easterly direction along the northern boundary of and including Portion E of the portion of the farm Braamfontein No. 53—I.R. to the north-eastern beacon thereof; thence generally in a south-easterly direction along the eastern boundary of and including Portion E of the portion and Portion G of the portion of the farm Braamfontein No. 53—I.R. to the south-eastern beacon of last-mentioned portion; thence generally in a south-westerly and general north-westerly direction along the southern boundary of and including Portion G of the portion and Portion E of the portion of the farm Braamfontein to the south-western beacon of last-mentioned portion, the point of commencement.

MELVILLE KOPPIES-PRIVAATNATUURRESERVAAT  
PRIVATE NATURE RESERVE

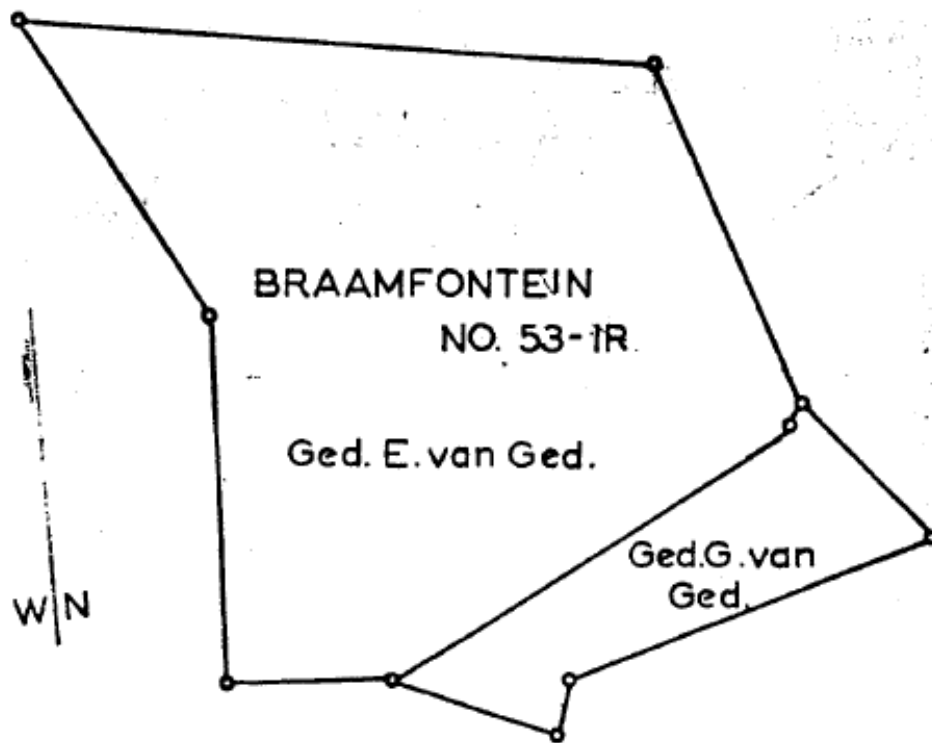

SKAAL:- 1:7500.  
SCALE:- 1:7500.